

5.8 Overview of lubrication points

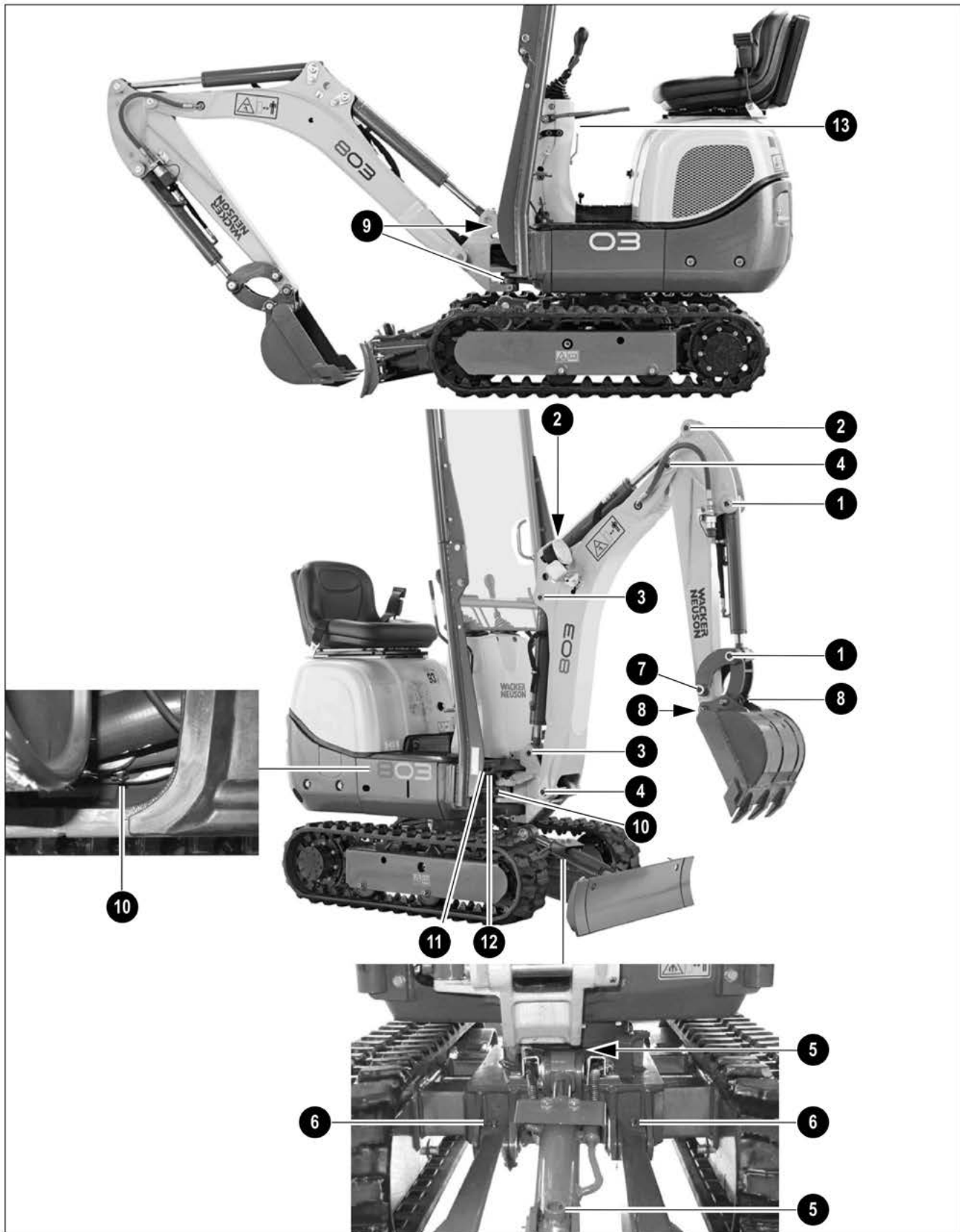

Pos.	Lubrication point	Quantity
1	Bucket cylinder	2
2	Stick cylinder	2
3	Boom cylinder	2
4	Boom	2
5	Stabilizer blade cylinder	2
6	Stabilizer blade	2
7	Stick	1
8	Bucket	2
9	Swiveling console	2
10	Swiveling cylinder	2
11	Live ring (ball bearing) – see chapter <i>Lubricating the live ring (ball bearing)</i> on page 5-22	1
12	Teeth of live ring – see chapter <i>Lubricating the teeth of the live ring</i> on page 5-23	1
13	Ball sockets (ISO/SAE changeover option)	2

Information!

Keep the lubrication points clean and remove ejected grease.

Parking the machine

Fig. 205: Parking the excavator

- Park the machine on level and horizontal ground.
- Lower the boom and the attachment to the ground.
- Lower the stabilizer blade to the ground.
- Stop the engine.
- Remove the starting key and carry it with you.
- Move joystick **15** and **16** in all directions repeatedly.
- Raise the lock lever.
- Get off the machine, lock the engine cover.

Swiveling cylinder lubrication points

Fig. 206: Engine cover lubrication point

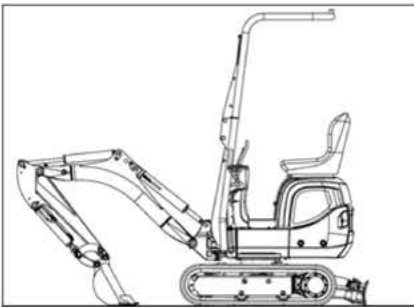
- Stop and park the machine.
- Open the engine cover.
- The lubrication point is located on the right under the engine cover.
- Apply grease to lubrication point **10** with a grease gun.
- Remove ejected grease.

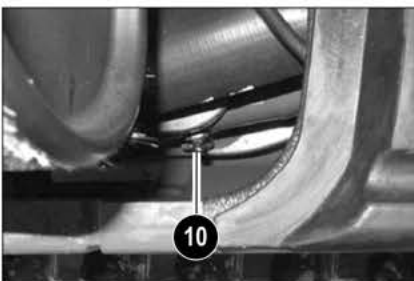
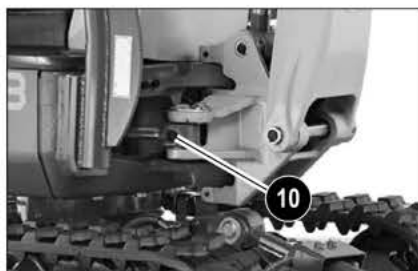

Fig. 207: Swiveling console lubrication point

- ☞ A further lubrication point is located on the right on the swiveling console.
- ☞ Apply grease to lubrication point **10** with a grease gun.
- ☞ Remove ejected grease.

Lubricating the live ring (ball bearing)



DANGER

Crushing hazard! Do not rotate the upper carriage during lubrication.

Serious crushing hazard causing death or serious injury.

- Stop and park the machine – see [chapter Parking the machine](#) on page 5-21.
- Do not rotate the upper carriage.

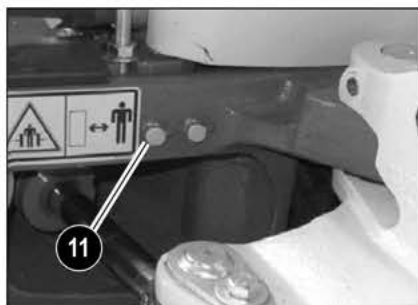

Fig. 208: Lubrication points of ball bearing race

- 1 Park the machine on firm, level and horizontal ground.
- 2 Lower the boom and the stabilizer blade to the ground.
- 3 Stop the engine, remove the starting key and carry it with you.
- 4 Raise the lock lever.

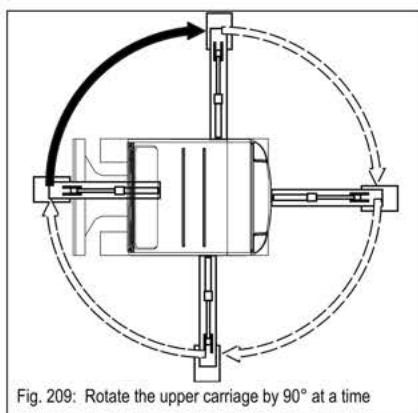

Fig. 209: Rotate the upper carriage by 90° at a time

- 5 Apply grease to lubrication point **11** with one stroke of the grease gun.
- 6 Start the engine, raise the boom and the stabilizer blade.
- 7 Rotate the upper carriage by 90°.
- 8 Repeat steps 2 – 7 three times until the upper carriage is back in its initial position.
- 9 Rotate the upper carriage several times by 360°.

Lubricating the teeth of the live ring



DANGER

Crushing hazard! Do not rotate the upper carriage during lubrication.

Serious crushing hazard causing death or serious injury.

- Stop and park the machine – *see chapter Parking the machine* on page 5-21.
- Do not rotate the upper carriage.

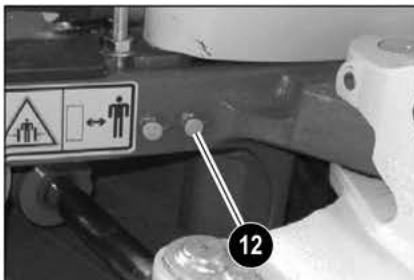

Fig. 210: Teeth lubrication point

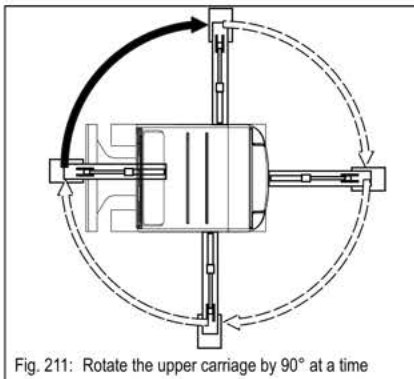

Fig. 211: Rotate the upper carriage by 90° at a time

- 1 Park the machine on firm, level and horizontal ground.
- 2 Lower the boom and the stabilizer blade to the ground.
- 3 Stop the engine, remove the starting key and carry it with you.
- 4 Raise the lock lever.
- 5 Apply grease to lubrication point **12** with five strokes of the grease gun.
- 6 Start the engine, raise the boom and the stabilizer blade.
- 7 Rotate the upper carriage by 90°.
- 8 Repeat steps 2 – 7 three times until the upper carriage is back in its initial position.
- 9 Rotate the upper carriage several times by 360°.