

5.17 Overview of lubrication points

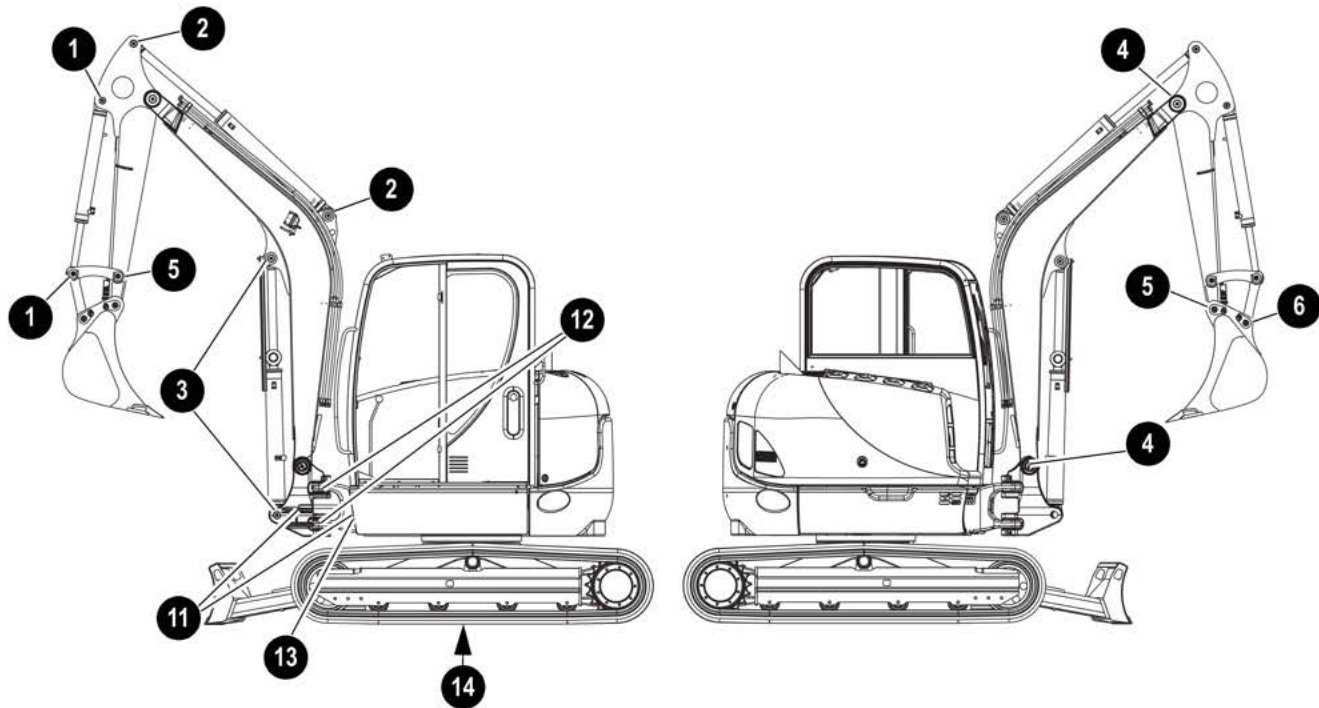

Stabilizer blade

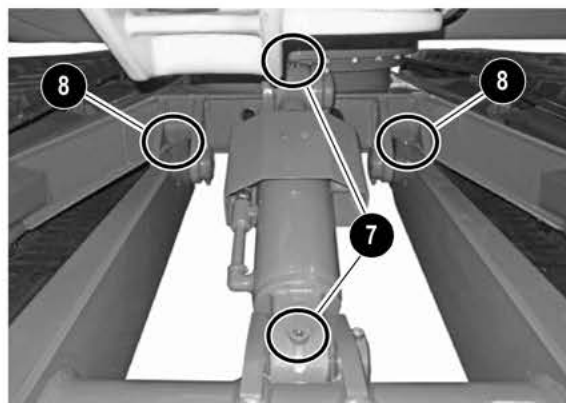

Triple articulation boom 6003 (option)

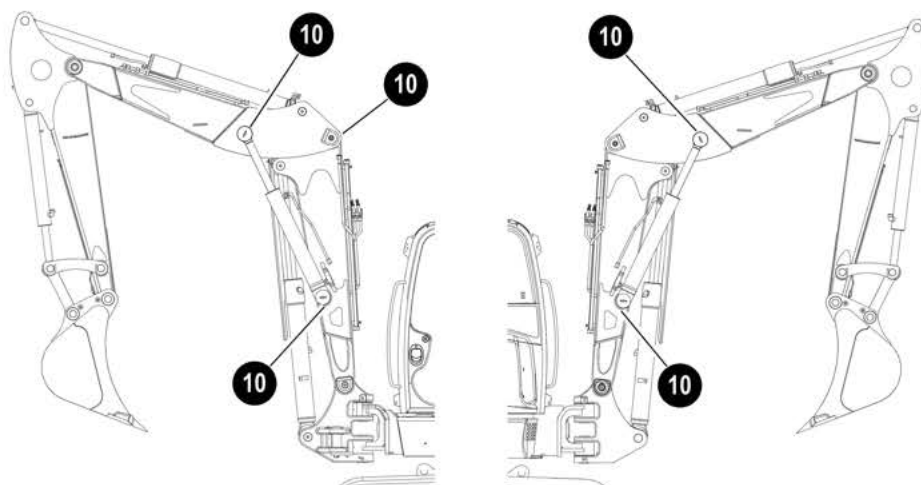

Pos.	Lubrication point	Interval	Quantity
1	Bucket ram	Daily	2
2	Stick ram	Daily	2
3	Boom ram	Daily	2
4	Boom	Daily	2
5	Stick	Daily	2
6	Joint rod	Daily	1
7	Stabilizer blade ram	Daily	2
8	Stabilizer blade	Daily	2
9	Triple articulation boom 6003 (option)	Daily	5
10	Slewing ram	Daily	2
11	Swivelling console	Daily	2
12	Ball bearing race of live ring	Every week	1
13	Teeth of live ring	Every week	1
14	Powerlift (option)	Daily	4
15	Hydraulic quickhitch (option)	Daily	2

Parking the machine

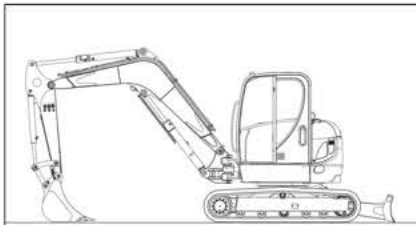

Fig. 303: Parking the machine

- Stop the machine on firm, level and horizontal ground.
- Position the boom straight ahead at the centre of the machine.
- Lower the stabilizer blade to the ground.
- Stop the engine.
- Operate the joystick repeatedly to release the pressure in the hydraulic system.
- Remove the ignition key and carry it with you.
- Move the control lever base in all directions repeatedly.
- Raise the control lever base.
- Close the windows and doors.
- Leave the cab.
- Close the door and the engine cover.
- Perform maintenance work.



Notice!

Keep the lubrication points clean and remove ejected grease.

Lubrication points on the boom, bucket and stick rams

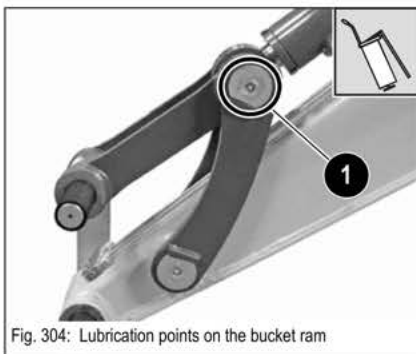

Fig. 304: Lubrication points on the bucket ram

- Apply grease to lubrication points 1 on the bucket ram.

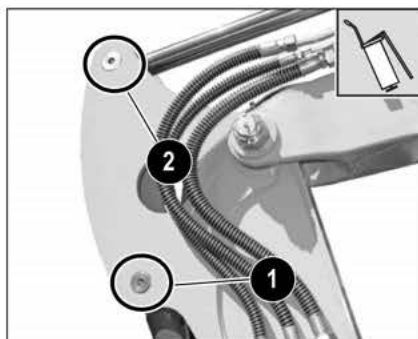

Fig. 305: Lubrication points on bucket and stick rams

- Apply grease to lubrication points **1** on the bucket ram.
- Apply grease to lubrication points **2** on the stick ram.

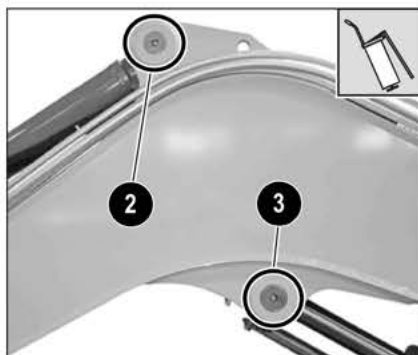

Fig. 306: Lubrication points on boom and stick rams

- Apply grease to lubrication points **2** on the stick ram.
- Apply grease to lubrication points **3** on the boom ram.

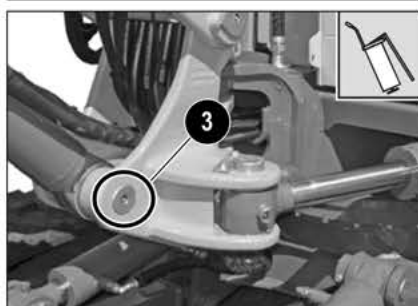

Fig. 307: Lubrication points on the boom ram

- Apply grease to lubrication points **3** on the boom ram.

Lubrication points on the boom and stick

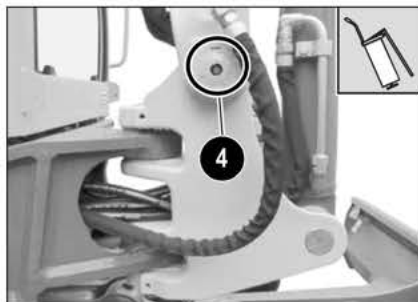

Fig. 308: Boom lubrication points

- Apply grease to lubrication points **4** on the boom.

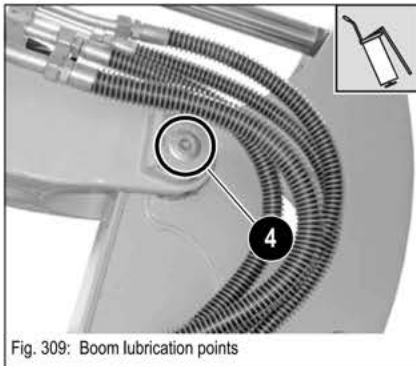

Fig. 309: Boom lubrication points

☞ Apply grease to lubrication points **4** on the boom.

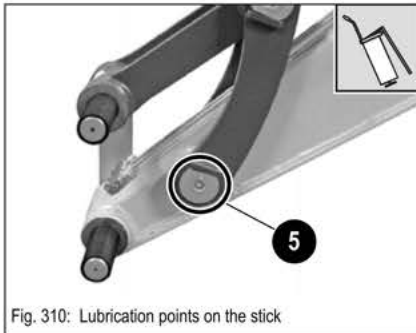

Fig. 310: Lubrication points on the stick

☞ Apply grease to lubrication points **5** on the stick.

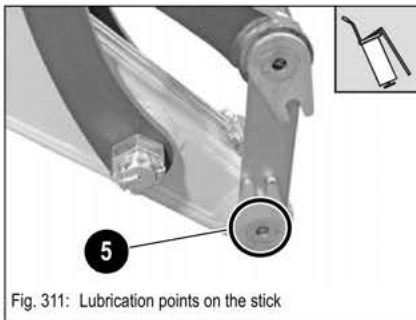

Fig. 311: Lubrication points on the stick

☞ Apply grease to lubrication points **5** on the stick.

Joint rod lubrication point

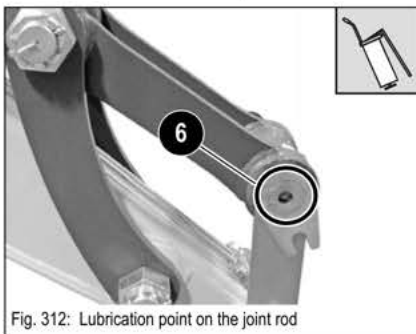

Fig. 312: Lubrication point on the joint rod

☞ Apply grease to lubrication point **6** on the joint rod.

Lubrication points on the stabilizer blade and stabilizer blade ram

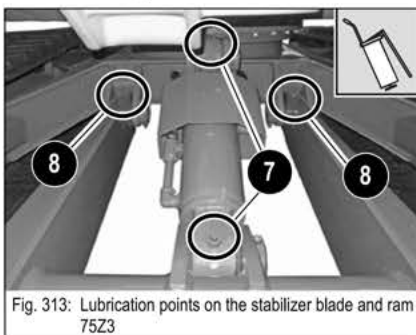

Fig. 313: Lubrication points on the stabilizer blade and ram
75Z3

☞ Apply grease to lubrication points **7** on the stabilizer blade ram.

☞ Apply grease to lubrication points **8** (on either side) on the stabilizer blade.

☞ Apply grease to lubrication points **9** on the stabilizer blade ram.

Lubrication points on the slewing ram and swivelling console

Fig. 314: Lubrication point on slewing ram

 Apply grease to lubrication points **11** on the slewing ram.

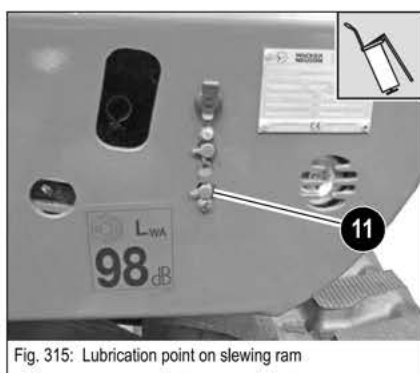

Fig. 315: Lubrication point on slewing ram

 Apply grease to lubrication point **11** of the offset ram.

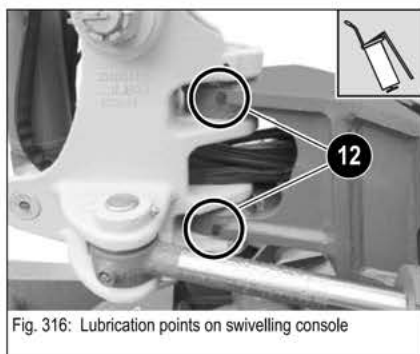



Fig. 316: Lubrication points on swivelling console

 Apply grease to lubrication points **12** of the swivelling console.

Lubrication points of ball bearing race of live ring



Danger!

Do not rotate the machine during lubrication.

Danger of severe crushing that can cause death or severe injury.

— see *Parking the machine* on page 5-43

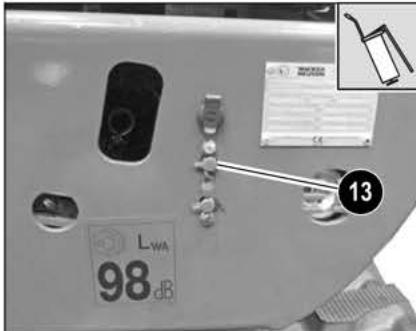

Fig. 317: Lubrication points of ball bearing race

- ☞ Stop and park the machine.
- ☞ Apply grease to lubrication points **13** with one stroke of the grease gun.
- ☞ Remove ejected grease.

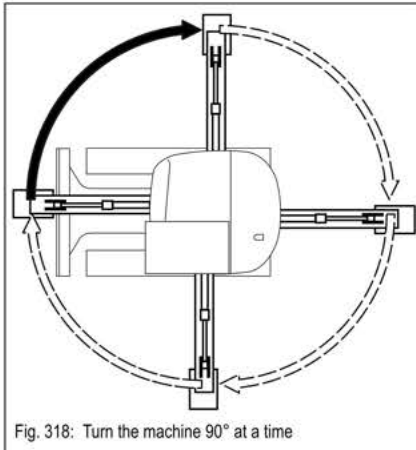

Fig. 318: Turn the machine 90° at a time

- ☞ Turn the machine 90° at a time.
- ☞ Stop and park the machine.
- ☞ Apply grease to each of lubrication points **13** with one stroke of the grease gun.
- ☞ Remove ejected grease.
- ☞ Turn the machine 360° a few times.

Lubrication points of live ring teeth



Danger!

Do not rotate the machine during lubrication.

Danger of severe crushing that can cause death or severe injury.

☞ – see *Parking the machine* on page 5-43



Caution!

Lubrication can be performed over a pit only.

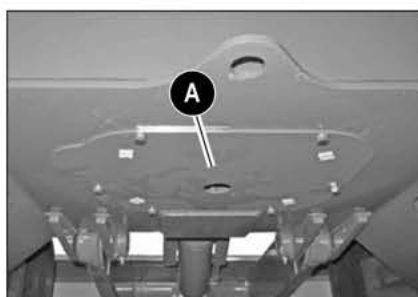

Fig. 319: Removing the cover

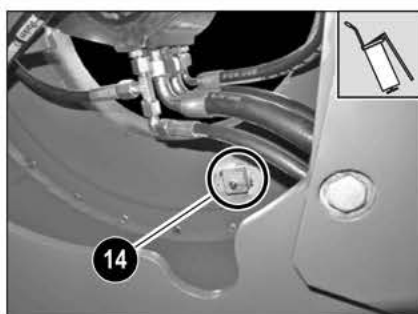

Fig. 320: Teeth lubrication point

- ☞ Drive and stop the machine over a pit.
- ☞ The lubrication point is located on the lower side of the travel gear.
- ☞ Remove cover **A** on the lower side with a suitable tool.

- ☞ Apply grease to lubrication point **14** with five strokes of the grease gun.
- ☞ Remove ejected grease.
- ☞ Install the cover.

Powertilt lubrication points (option)

Fig. 321: Powertilt lubrication points

Perform maintenance of the Powertilt unit once a day with the other maintenance work for the machine.

Perform visual checks for possible defects, damage or cracks.

Remove all dirt on and around moving parts.

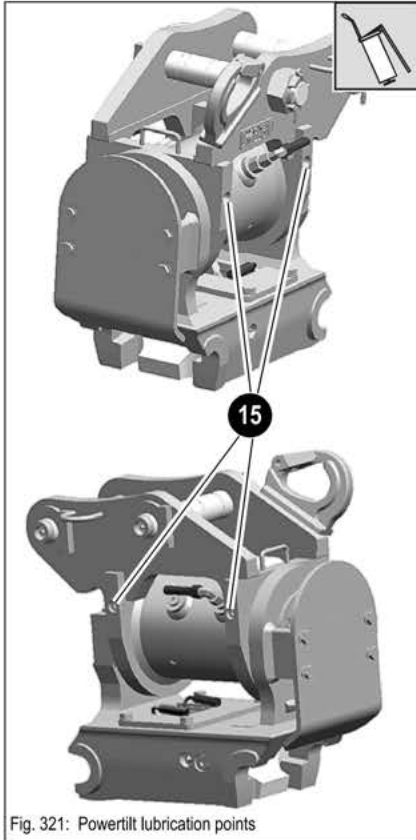
Apply grease via grease nipples **15**.

– see [chapter 3.60 Powertilt \(option\)](#) on page 3-110

Lubrication points of hydraulic quickhitch (option)

Fig. 322: Quickhitch lubrication points

Notice!

Before picking up an attachment, the driver must ensure that it can be hitched correctly by removing all dirt on either claw of the quickhitch.

Perform maintenance on the quickhitch once a day with the other maintenance work for the machine.

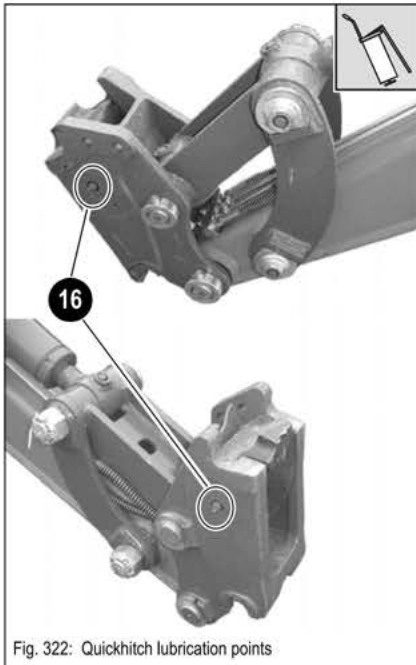
Perform visual checks for possible defects, damage or cracks.

Remove all dirt on and around moving parts.

The claws must be clean and slightly greased.

Apply grease to the friction surfaces of the lock mechanism via 2 grease nipples **16** on either side of the quickhitch (see [Fig. 322](#)).

Before starting work, check the acoustic signal. You must be able to hear the acoustic signal as you actuate the switch.

Lubrication points of control lever base (from serial no. AJ02777)

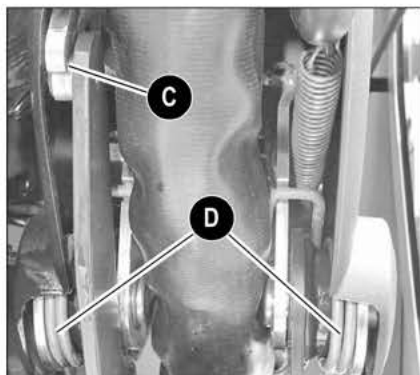

Fig. 323: Guide lever and double spring

- ☞ Raise the control lever base.
- ☞ Spray fluid grease onto guide lever **C**.
- ☞ Spray fluid grease on both sides of double spring **D**.



Notice!

Spray fluid grease onto the lubrication points once a month (250 s/h).



Danger!

In the area of the moving parts of the control lever base –

Crushing hazard.

☞ Stay clear (extremities, clothing) of the moving parts.

VDS lubrication points (option)

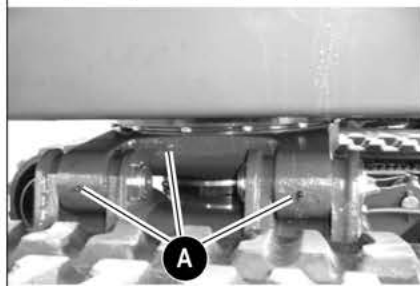
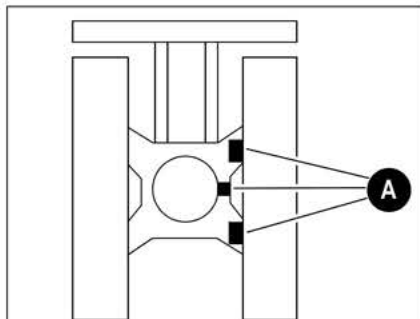

Fig. 324: VDS lubrication points

Apply grease to lubrication points **A** once a week.

5.18 Central lubrication system (option)

Grease-based central lubrication system with 12 lubrication points.
Not in connection with triple articulation boom (option).

Function

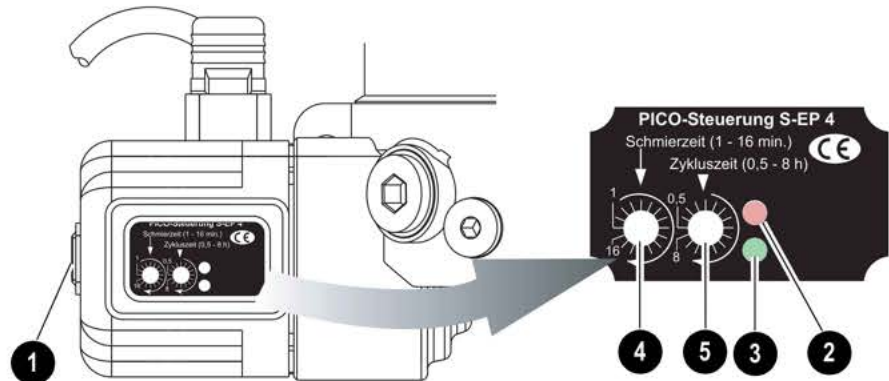

Pos.	Designation
1	Push button on motor housing
2	Red LED
3	Green LED
4	Lubrication time potentiometer
5	Cycle time potentiometer

The green LED illuminates for about 1.5 sec once ignition is switched on to indicate readiness. Pressing the push button on the pump's motor housing switches on the pump and starts the lubrication cycle. The pump drive motor is switched off and cycle time begins once lubrication time is over.

All further lubrications start automatically according to the cycle time set.

Lubrication time is stopped and saved if ignition or lubrication is switched off during cycle time. The data is read from the memory upon switching ignition on again, and lubrication is resumed where it was interrupted.

Pressing the push button on the motor housing or on the instrument panel starts intermediate lubrication if ignition is switched on.

Status LEDs

Indication	Meaning
Green LED 1.5 sec	Ignition on (operational readiness)
Steady green light	Illuminates during lubrication
Steady red light	Grease level error Remains lit until grease tank is refilled
Blinking red light	Overpressure error

Adjusting cycle time and lubrication time

Adjust the cycle time and the lubrication time with the potentiometers.

Lubrication time
1 min to 16 min

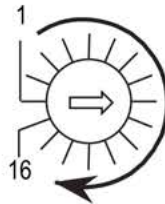

Cycle time
0.5 h to 8 h

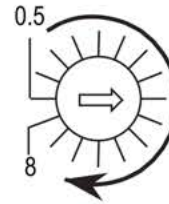

Repair in case of clogging

Clogging indication

Overpressure beyond operating pressure means the system is clogged and is indicated as follows:

- Grease escapes by the pressure limiting valve.
- Blinking red LED on the pump housing.

Causes for clogging in the system

- Squeezed or blocked lubrication line.
- Bearing blocked or overfilled with lubricant.
- Lubricant not suitable for central lubrication systems.
- Blocked distributor.

Detecting clogging

- ☞ Unscrew the main line off the main distributor.
- ☞ Actuate the pump with the push button and check whether the lubricant is delivered correctly.
- ☞ Screw the main line onto the main distributor.
- ☞ Unscrew the lines one after another and actuate the pump every time.

Repairing a clogged distributor

- ☞ Remove the distributor from the system.
- ☞ Unscrew the screw plug of the piston bore.
- ☞ Move the piston back and forth (do not remove).
- ☞ Screw the screw plugs back in again.

You can remove the piston of the malfunctioning distributor and check it for scratches or damage.

If there are traces of hardened grease on the piston or the bores, remove the grease with compressed air or by washing the piston.



Notice!

Traces of hardened grease are a sign that the grease is not suitable for central lubrication systems.