

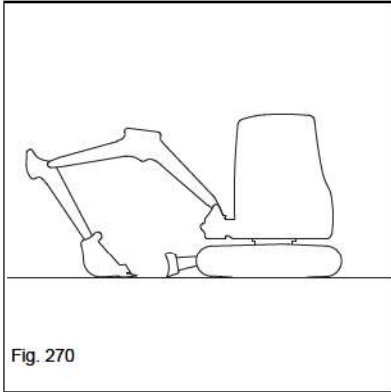

## Preparing lubrication



1. Stop the vehicle on firm, level, and horizontal ground.
2. Position the boom straight ahead at the center of the vehicle.
3. Lower the boom and the stabilizer legs to the ground.
4. Stop the engine.
5. Operate the control lever repeatedly to release the pressure in the hydraulic system.
6. Raise the control lever base.
7. Remove the starting key and carry it with you.
8. Safely store all loose objects.
9. Close the windows and doors.
10. Close and lock all covers.
11. Attach a warning label to the control elements (for example **“Machine being serviced, do not start”**).

Wait at least 10 minutes after stopping the engine.



### **Information**

Keep all lubrication points clean and remove any escaping grease.

One-piece boom

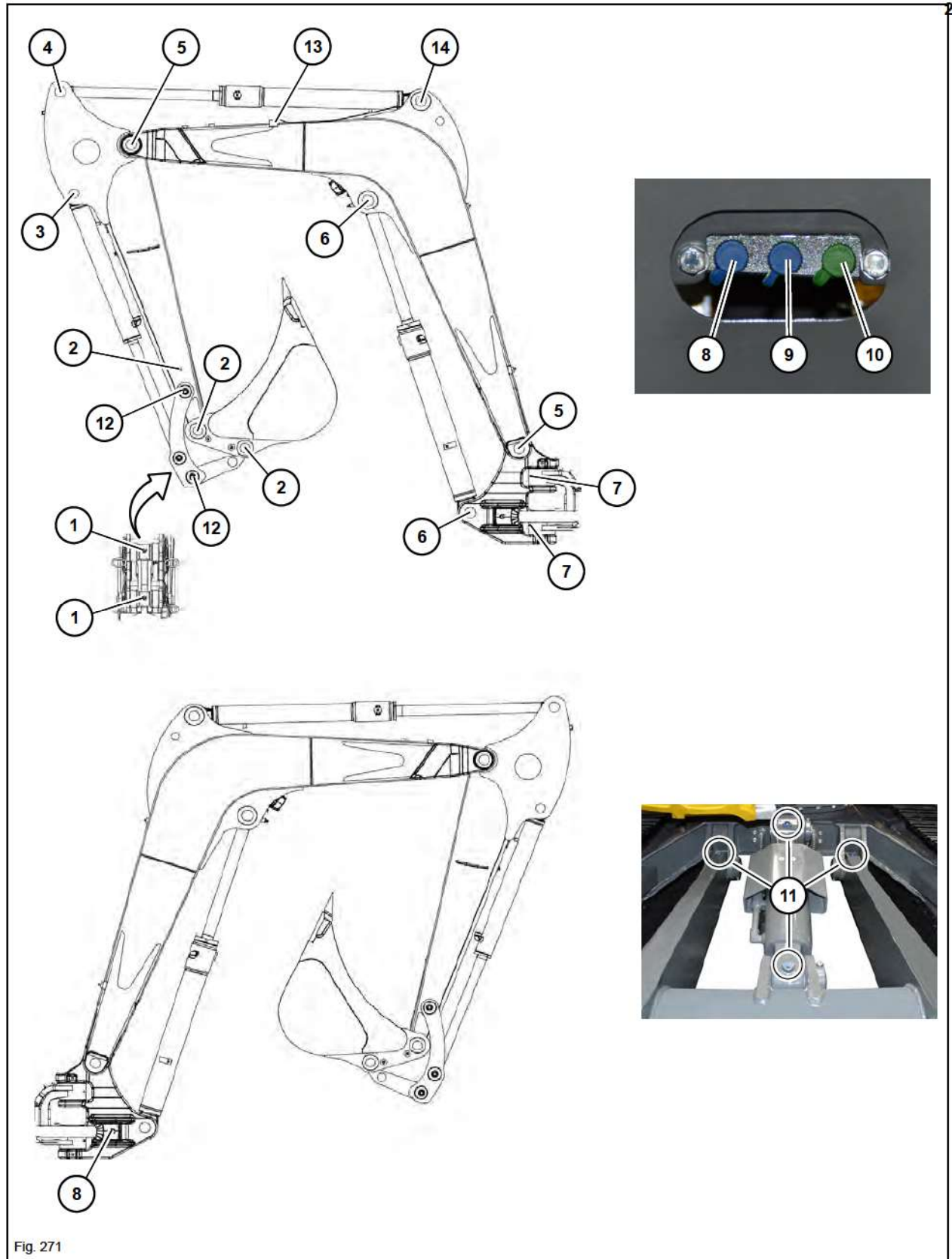

Fig. 271



Position	Lubrication point <sup>1</sup>	Interval	Quantity
1	3-pin pivot plate	Daily	2
2	Shovel arm	Daily	3
3	Bucket cylinder	Daily	1
4	Stick cylinder	Daily	1
5	Boom	Daily	2
6	Boom cylinder	Daily	2
7	Swiveling console	Daily	2
8	Swiveling cylinder	Daily	2
9	Live ring teeth (authorized service center)		1
10	Live ring (ball bearing) <i>– see chapter “Live ring (ball bearing)” on page 7-15</i>	Daily	1
11	Stabilizer blade	Daily	4
12	Stick (EZ80)	Daily	2
13	Stick cylinder (ET65)	Daily	1
14	Stick cylinder (EZ80, ET90)	Daily	1

1. Lubrication on the pins or directly on the cylinders

Triple boom (option ET65/ET90)

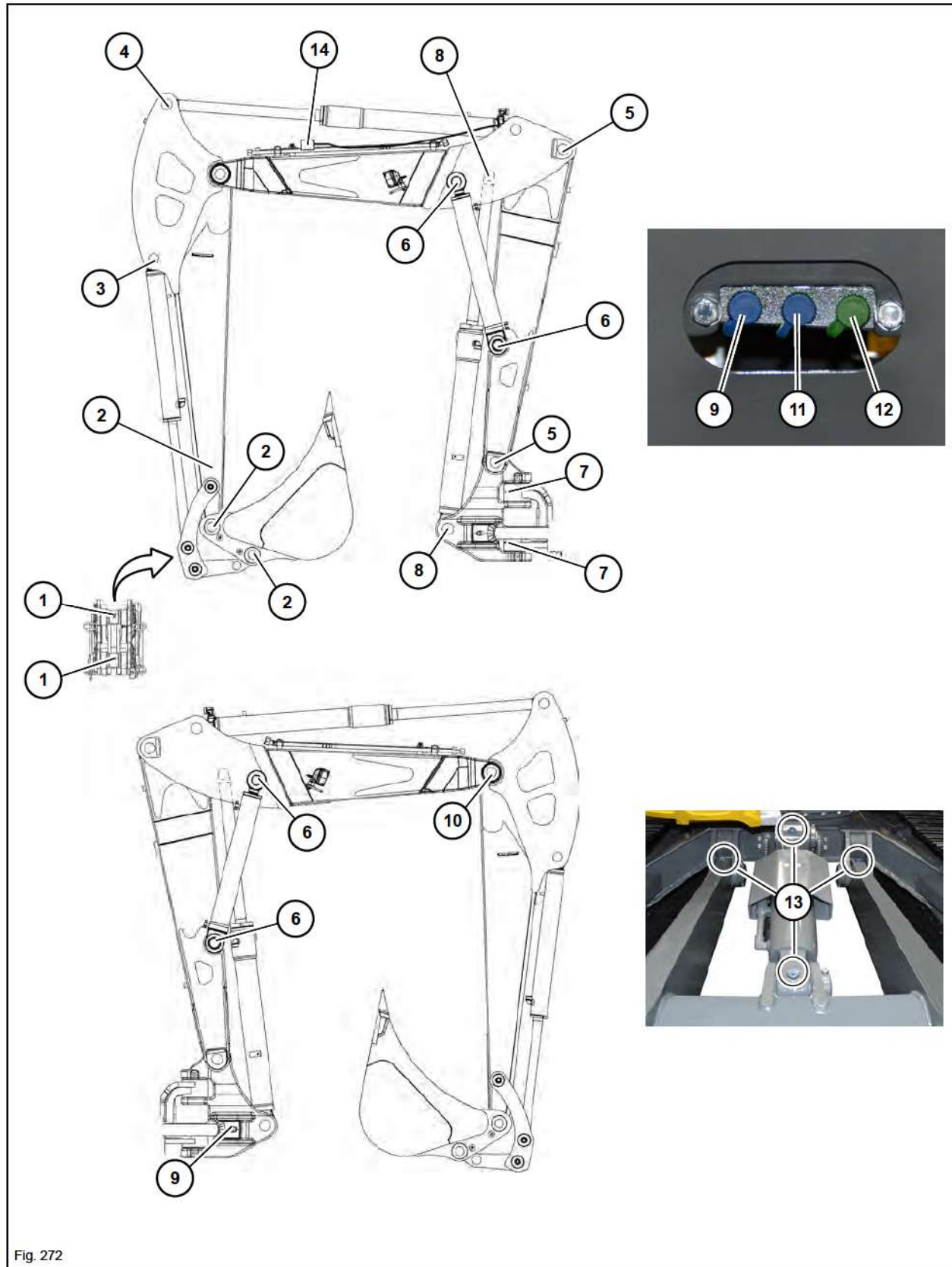



Position	Lubrication point	Interval	Quantity
1	3-pin pivot plate	Daily	2
2	Shovel arm	Daily	3
3	Bucket cylinder	Daily	1
4	Stick cylinder	Daily	2
5	Boom	Daily	2
6	Triple articulation boom cylinder	Daily	4
7	Swiveling console	Daily	2
8	Boom cylinder	Daily	2
9	Swiveling cylinder	Daily	2
10	Triple articulation boom	Daily	1
11	Live ring teeth (authorized service center)		1
12	Live ring (ball bearing) – see chapter “Live ring (ball bearing)” on page 7-15	Daily	1
13	Stabilizer blade	Daily	4
14	Remote lubrication point stick cylinder	Daily	1

Cabin/attachment mounts

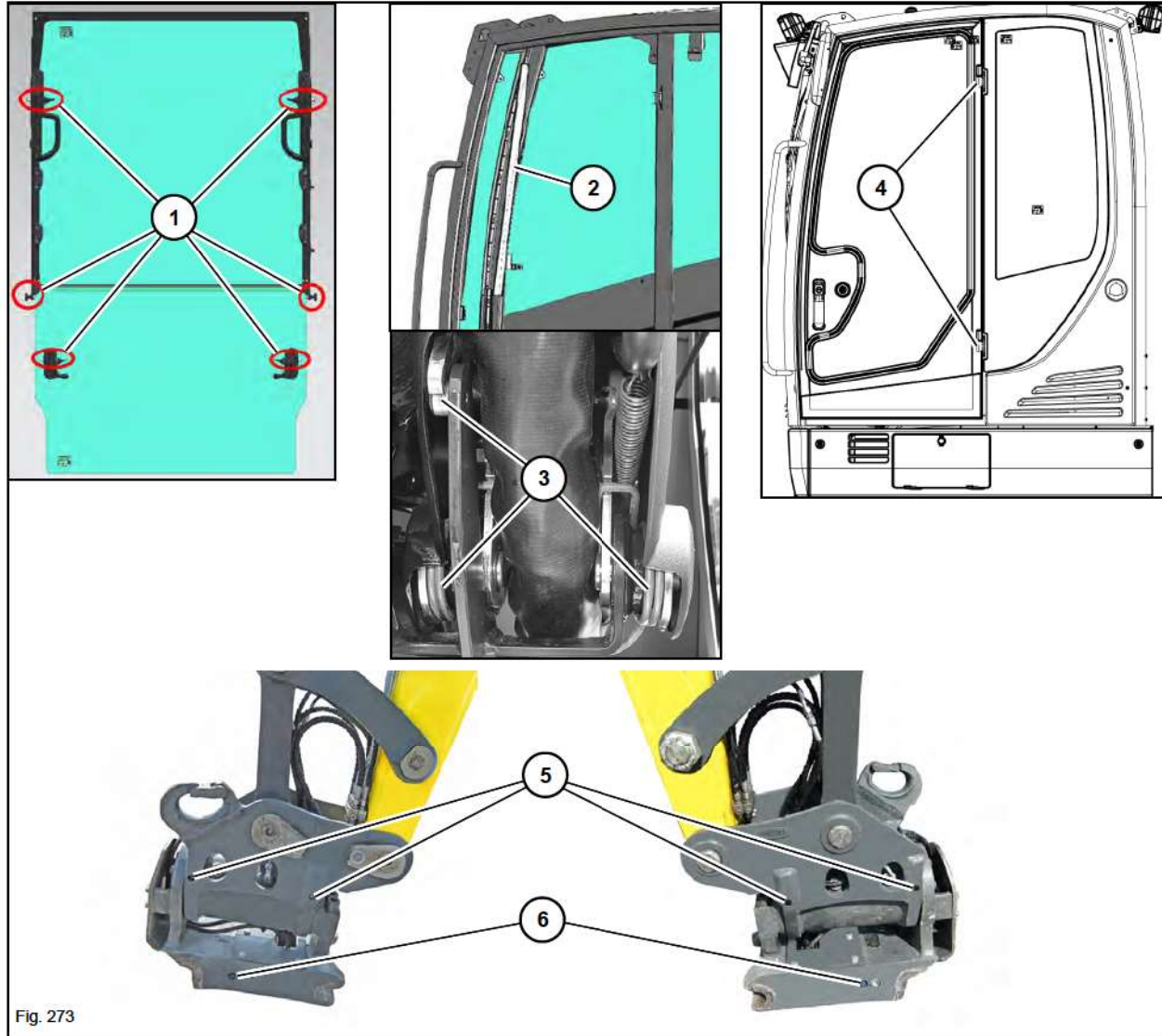

Fig. 273

Position	Lubrication point	Interval	Quantity
1	Front window: pin, lock notches and locks	Every week	6
2	Windshield: guide rails	Every week	2
3	Control lever base – see chapter “Control lever base” on page 7-16	Every week	3
4	Door hinges	Every week	2
5	Powertilt (option)	Daily	4 <sup>1</sup>
6	Hydraulic quickhitch (option)	Once a day/once a week	2 <sup>1</sup>

1. Apply grease to grease zerks twice daily after operation in water to remove all traces of water.

## Live ring (ball bearing)

### **DANGER**

#### **Crushing hazard during lubrication!**

Serious crushing hazard causing death or serious injury.

- ▶ No one must be in the danger zone during upper carriage rotation.

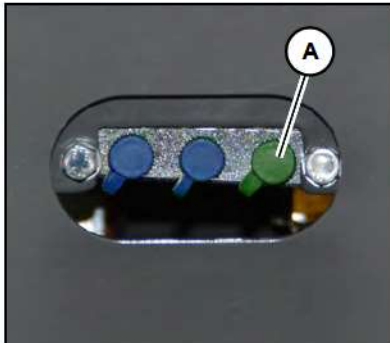

Fig. 274

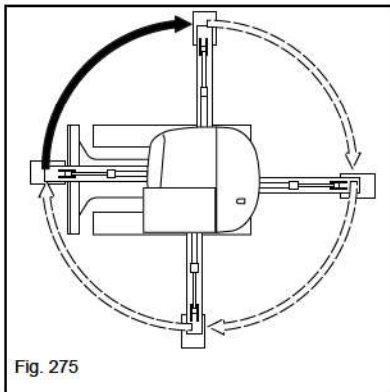

Fig. 275

The lubrication points are located on the right side of the upper carriage.

1. Park the vehicle on firm, level, and horizontal ground.
2. Lower the boom and the stabilizer blade to the ground.
3. Stop the engine, remove the starting key and carry it with you.
4. Apply grease to lubrication point **A** with two strokes of the grease gun.
5. Start the engine, raise the boom and the stabilizer blade.
6. Rotate the upper carriage by 90°.
7. Repeat steps 2-6 three times until the revolving upper carriage is back in its initial position.
8. Rotate the upper carriage several times by 360°.

## Control lever base



### CAUTION

Crushing hazard in the area of the moving parts of the control lever base!

Injury hazard due to crushing of parts of body.

- ▶ Stay clear (extremities, clothing) of the moving parts.

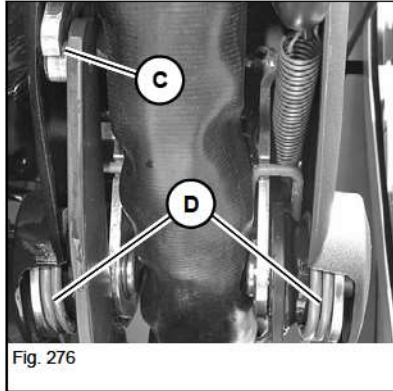

1. Raise the control lever base.
2. Spray fluid grease onto the guide lever in the area of **C**.
3. Spray fluid grease on both sides **D** of the double spring.

## Powertilt with Easy Lock – operation in water

- Apply grease to the lubrication points before using in water.
- After using in water, apply grease to the lubrication points to remove all water.